

8. County Highway FF Milling and Paving
- A, PROPOSED 2011 BONDING - \$1,600,000
- B. PROJECT COSTS AND SOURCES OF FUNDS:

PROJECT COSTS:	2013	2014	2015	2016	2017	Total
Planning & design						\$ -
Land purchase						-
Construction	1,750,000					1,750,000
Equipment						-
Other						-
<b>Total costs</b>	<b>1,750,000</b>	<b>-</b>	<b>-</b>	<b>-</b>	<b>-</b>	<b>1,750,000</b>
<b>PROJECT FUNDS:</b>						
G.O.Bonds or notes	1,600,000	-	-	-	-	1,600,000
Fed and State funds	150,000					150,000
Tax levy						-
Other						-
<b>Total funds</b>	<b>\$ 1,750,000</b>	<b>\$ -</b>	<b>\$ -</b>	<b>\$ -</b>	<b>\$ -</b>	<b>\$ 1,750,000</b>

C. DESCRIPTION AND JUSTIFICATION:

**Project Description:** Remove existing surface through profile milling process. Then overlay existing roadway with a 4" mat of asphalt 22 feet in width at minimum, possibly install paved shoulder where feasible. Center stripe, edge line and shoulder remainder of project. This project is approximately 5 miles in length.

**Relationship to other projects and plans:** No relation to any other project.

**Justification and alternatives considered:** The road is showing significant signs of deterioration with some area rutting and areas of cracking. Future maintenance problems will not be alleviated by using minor repair methods. Milling and overlaying the existing roadway will prolong the life of this segment of county trunk highway approximately 20 to 25 years.

**ANNUAL OPERATING IMPACT:** The primary objective is to make the road better and safer for the public to use. Continuing to let the road deteriorate could result in much more costly resurfacing in the future, especially if the road base is allowed to significantly deteriorate. There is some annual maintenance for patching but it is not significant.



Winnebago Co. Highway Dept.  
2013 Capital Improvement Plan

CTH FF

Mill and Pave STH 44 to County Line

See Page 12 - OMRO and RUSHFORD (SE)

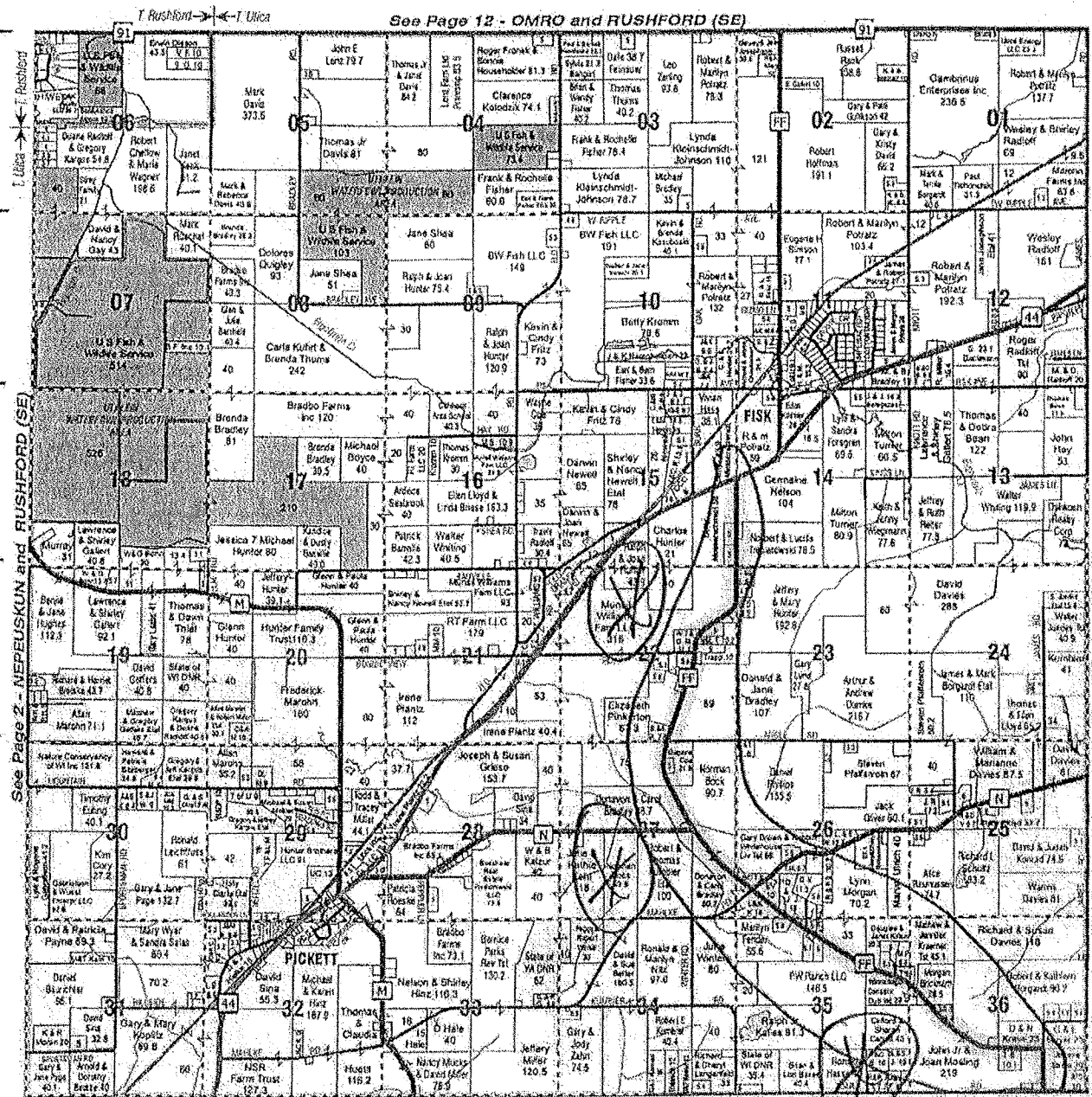

Fond Du Lac County

7800

© 2011 - Winnebago County, WI - <http://www.co.winnebago.wi.us/>