

**TO THE WINNEBAGO COUNTY BOARD SUPERVISORS**

Your Planning and Zoning Committee begs leave to report:

WHEREAS, it has reviewed the Petition for Zoning Amendment 11-ZC-008 filed with the County Clerk by:

Bindi LLC c/o Chandrakant B Patel, Town of Menasha  
and referred to the Planning and Zoning Committee on July 19, 2011 and

WHEREAS, a Public Hearing was held on July 26, 2011, pursuant to mailed and published notice as provided by as on the following:

**PROPERTY INFORMATION:**

*Owner(s) of Property:* Bindi LLC c/o Chandrakant B Patel  
*Applicant(s):* David Viaene

*Location of Premises Affected:* 2000 Holly Rd

*Legal Description:* Being a part of the SE 1/4 of the SE 1/4, Section 4, Township 20 North, Range 17 East, Town of Menasha, Winnebago County, Wisconsin.

*Tax Parcel No.:* 008-0145-03

|                 |   |                                     |                                    |   |
|-----------------|---|-------------------------------------|------------------------------------|---|
| <i>Sewer:</i>   | <input checked="" type="checkbox"/> Existing  | <input type="checkbox"/> Required   | <input type="checkbox"/> Municipal | <input type="checkbox"/> Private System |
| <i>Overlay:</i> | <input type="checkbox"/> Microwave            | <input type="checkbox"/> Airport    | <input type="checkbox"/> SWDD      |   |
|                 | <input checked="" type="checkbox"/> Shoreland | <input type="checkbox"/> Floodplain | <input type="checkbox"/> Wetlands  |   |

WHEREAS,

Applicant is requesting a rezoning to B-3(HB) (General Business -Highway Business overlay)

And

WHEREAS, we received notification from the Town of Menasha recommending Approval

And

WHEREAS, your Planning and Zoning Committee, being fully informed of the facts, and after full consideration of the matter, making the following findings:

1. Town of Menasha has approved.
2. Town findings for approval were as follows: a) Town does have an adopted land use plan b) Action does agree with adopted Town plan c) The current zoning district of the property does not allow motels or hotels, so this overlay is a requirement for its use as a motel d) This rezoning will not have any impact on the future use of the property if the motel use does not continue.
3. There were no objectors.
4. Proposed use is compatible with adjacent uses.

NOW THEREFORE BE IT RESOLVED, that this committee hereby reports our findings for your consideration and is hereby recommending Approval. (4-0-1 absent: Thompson)

AND BE IT FURTHER RESOLVED, by the Winnebago County Board of Supervisors, that the enclosed Ordinance is hereby [ADOPTED] OR [DENIED].

---

For the Planning and Zoning Committee

**AMENDATORY ORDINANCE # 08/01/11**

The Winnebago County Board of Supervisors do ordain Zoning Amendment # 11-ZC-008 as follows:

Being a part of the SE 1/4 of the SE 1/4, Section 4, Township 20 North, Range 17 East, Town of Menasha, Winnebago County, Wisconsin.

FROM: B-3 (General Business)

TO: B-3(HB) (General Business -Highway Business overlay)

Adopted this \_\_\_\_\_ day of \_\_\_\_\_, 20\_\_\_\_

David Albrecht, Chairperson

ATTEST:

Susan T. Ertmer, Clerk

APPROVED

VETOED

APPROVED BY WINNEBAGO COUNTY EXECUTIVE THIS \_\_\_\_\_ DAY OF \_\_\_\_\_, 20\_\_\_\_.

\_\_\_\_\_  
Mark Harris  
County Executive



Application # 11-ZC-008

Date of Hearing:

July 26, 2011

Owner(s):

Bindi LLC

Subject Parcel(s):

008014503



Winnebago County  
WINGS Project

Scale  
1 inch : 300 feet

County Zoning Legend

|              |              |           |
|--------------|--------------|-----------|
| R-1          | B-1          | A-1       |
| R-2          | B-2          | A-2       |
| R-3          | B-3          | A-2 (ADO) |
| R-4          | B-3(HB)      | P-1       |
| R-5          | B-3 (HB-AEO) | M-1       |
| MH-1         | B-4          | M-2       |
| INCORP. AREA | B-5          | EXT       |

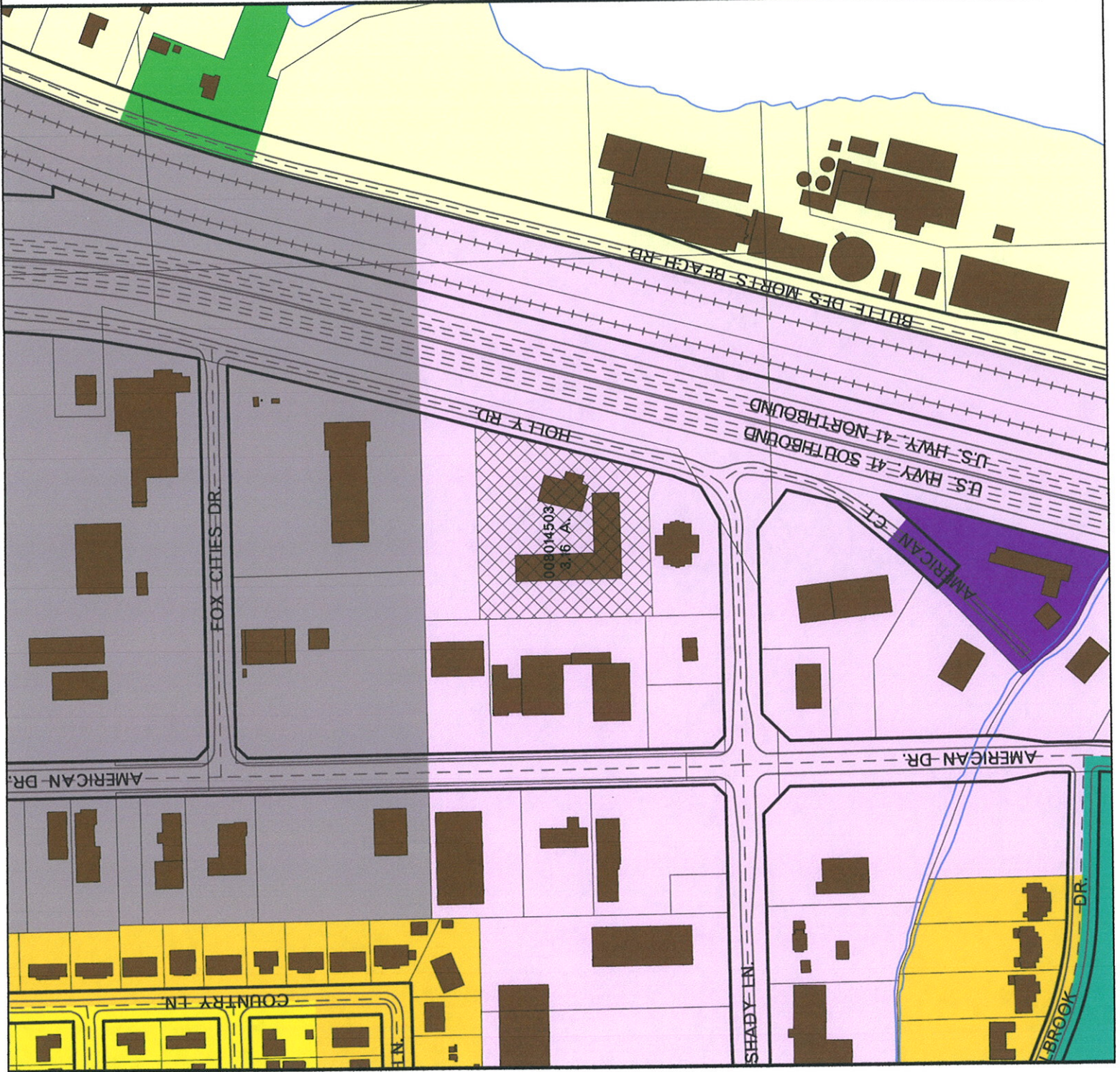



**O = SITE**

[illegible]

Owner(s):

**Subject Parcel(s):**

Winnebago County  
WINGS Project

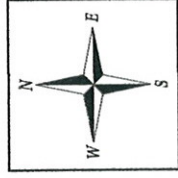

● SITE

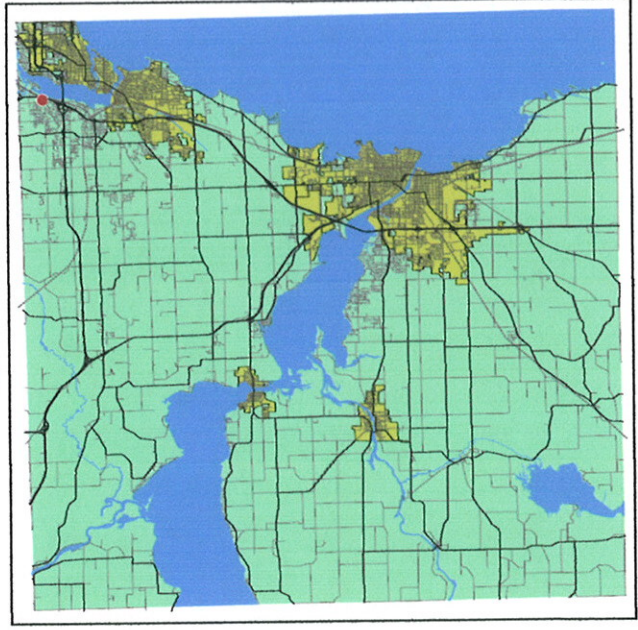

WINNEBAGO COUNTY

Scale 1 inch : 2000 feet