

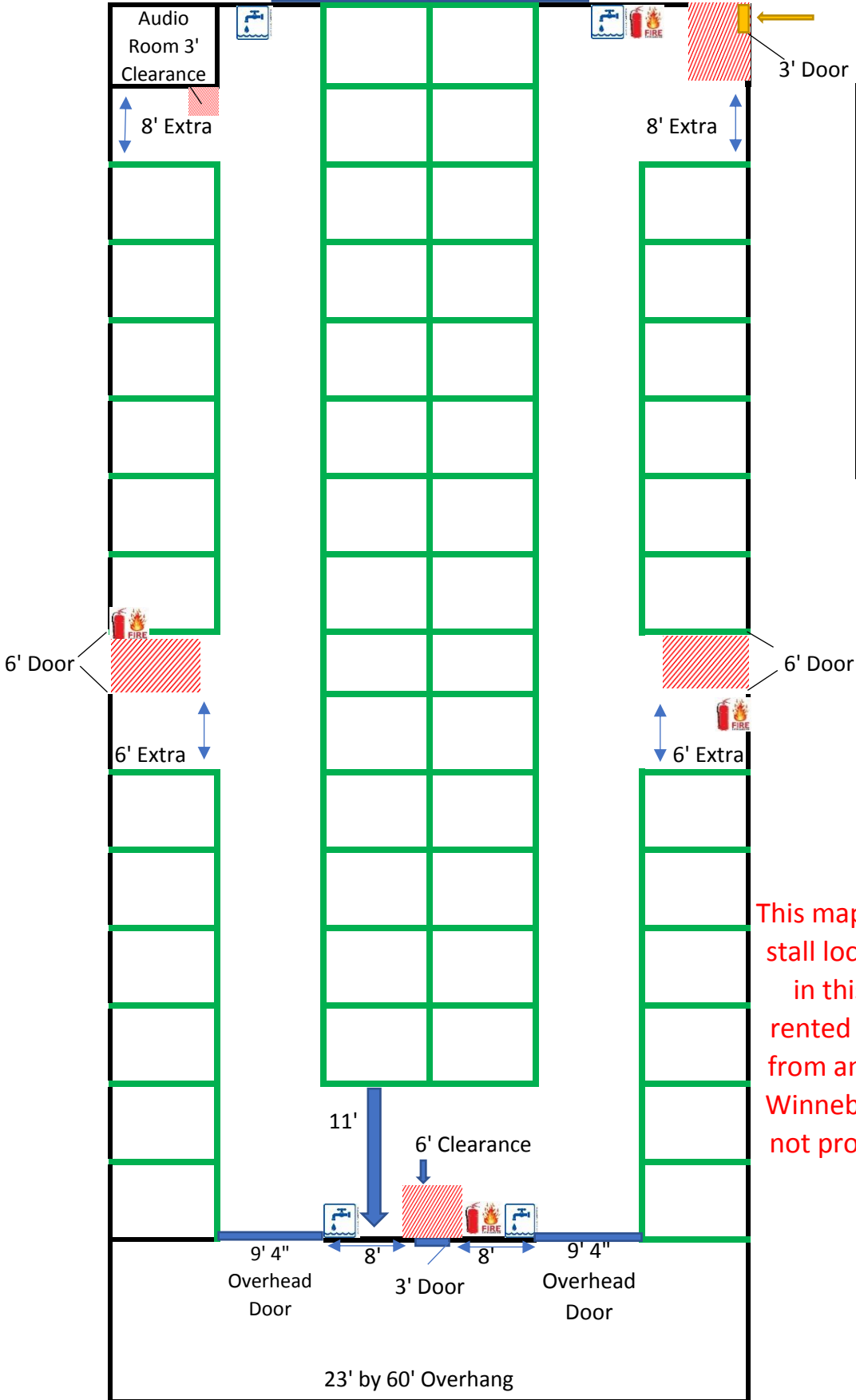



# Barn A

29' 6" sliding door

Electrical Panel 3'  
Clearance



## Key

-  Fire Code Access
-  Fire Extinguisher
-  Water Faucet
-  Electrical Panel (min 3' clearance)

52 potential stalls

This map shows **POSSIBLE** stall locations. Any stalls in this barn must be rented by the promoter from an outside agency. Winnebago County does not provide any stalls in this barn.